

M

Microwave

The kitchen is equipped with a microwave oven (just above the large oven)

As with all microwaves do not place metal or any item marked as not suitable for microwave in the oven.

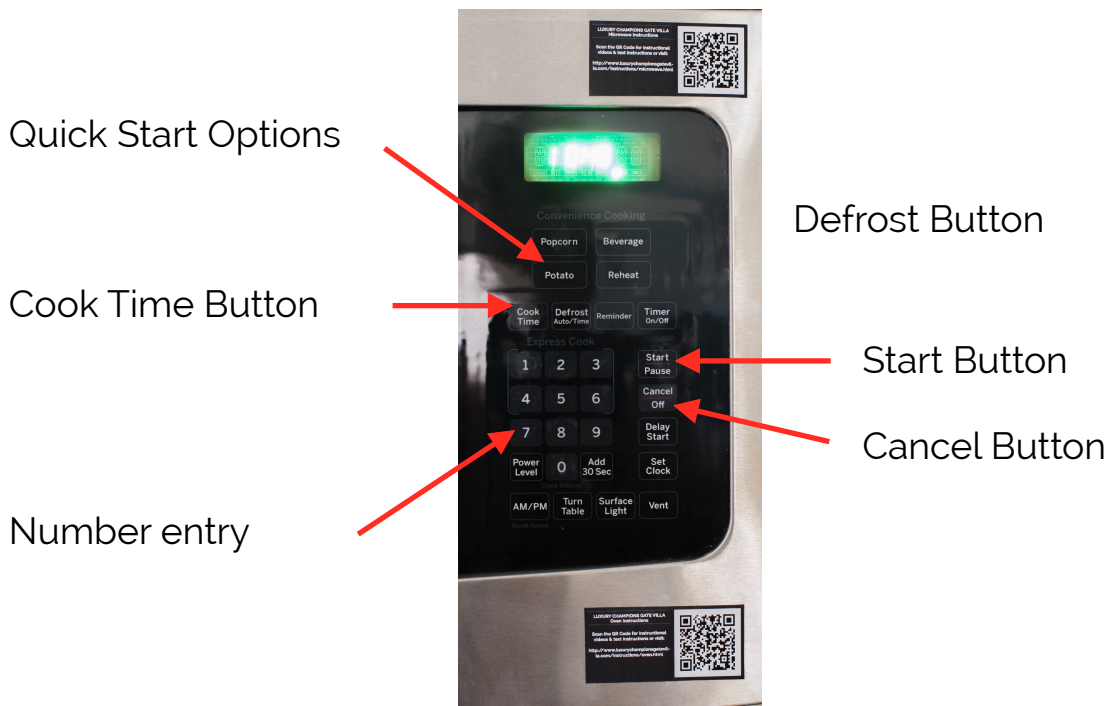

For standard usage press COOK Time then use the numbers to enter the minutes or seconds and press START.

There are quick start options for Popcorn, Beverage, Potato and Reheat which will start automatically with a single press of the button.

To use the Defrost option press DEFROST then enter the weight of the item in Lbs and the microwave will automatically calculate the time and start defrosting.